

Case Study

Vistry Homes, Huntingdon

TORiser





Case Study



M & J EVANS, **Vistry Homes,** Huntingdon



The Groundworks
Partner of Choice

Vistry Works

TORiser

Lightweight Access cover and Gully Raising Pieces

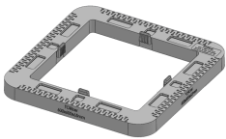

Seating Ring

675 x 675

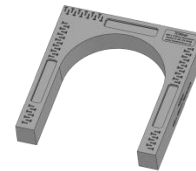

Horseshoe

Gully Riser

Both TORiser seating rings and horse shoes have been supplied and installed on the Vistry Homes, Edison Bell Way, Huntingdon.

Case Study

Time saving & Health and Safety Compliant

As both units are under 7kg no machinery was required to carry out any of the ironwork raising.

With a two-man team this means the process is twice as fast with each man able to raise his own unit independently.

Under
7Kg
Per unit



Case Study



90% Lighter
100% Up for the Job

Cost Effective & Money Saving

TORiser doesn't cost more than concrete and once you factor in the manpower and machine savings it's both

Quicker and Cheaper.

Case Study

No Wastage Or Breakages in transit

Every unit delivered to site was intact and all units were installed.

No waste filling expensive skips.

- ✓ **D400 Loading—WRC Certified for use in the public highways**
- ✓ **Under 7KG per unit — Heath and Safety Compliant - One Man Install**

90%

Lighter than Concrete
equivalent

2x

Faster installation to the
concrete equivalent



Meet The Team

TORiser is specifically designed to significantly reduce Time, Wastage & Plant movements

100%

Client Satisfaction

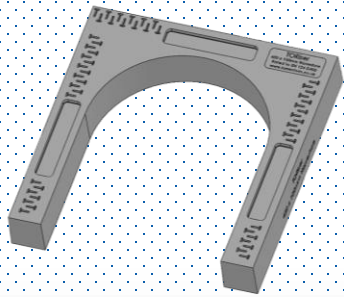

Horseshoe
Gully Riser

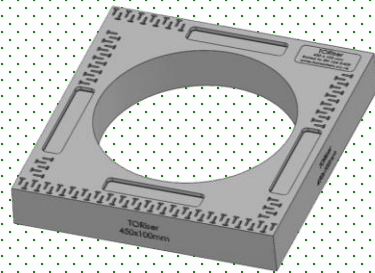

Square
Gully Riser

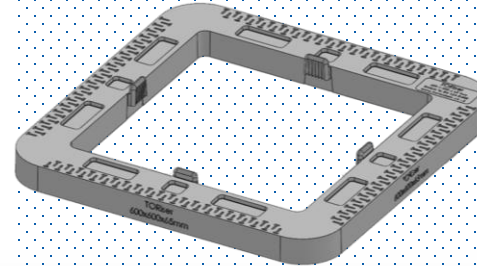

675 x 675
Seating Ring

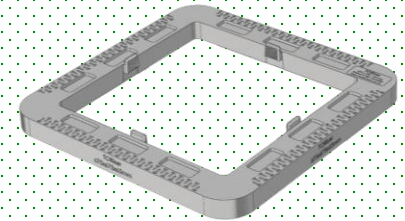

600 x 600
Seating Ring

Contact Us

- All **TORiser** units weigh less than 7kg meaning manual handling is handled.
- TORiser** is a one-man lift meaning a two-man crew will install two simultaneously. **TWICE AS FAST!**
- TORiser** can be carried by the operative meaning machines are free to carry on with other tasks. Speeding up other projects on site.
- TORiser** is installed using the same detail as concrete meaning no special training or products.
- TORiser** is currently made from 20% recycled material but is fully recyclable after use.
- TORiser** will show at least a 25% reduction in Carbon CO2e based on similar products against typical concrete units.
- TORiser** lightweight structure means more products per load reducing the impact from delivery vehicles.
- TORiser** has independent testing and certification from WRC plus over two years empirical evidence of installs across the country in all highway settings.

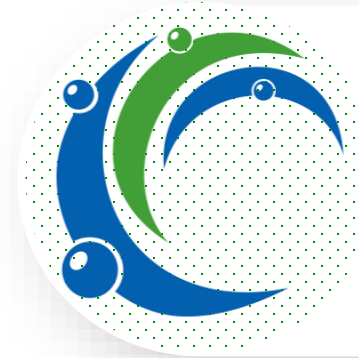

TORRENT
WATER MANAGEMENT



01623 272882



enquiries@torrentwm.co.uk